

Model	A mm	B mm	C mm
RTRC 3000x50	190	56	88
RTRC 3000x80	220	86	118

Model	Smax mm	Max. punching force	Gas spring return force		Gas spring model	Max. working specifications		Max. width of driver	Kg
			Initial	Final		Velocity	Strokes / min		
RTRC 3000x50-1	50	3000 daN	400 daN	≈ 600 daN	TPK 32x50	0,5 m/s	40	35 mm	9,2
RTRC 3000x50-2			200 daN	≈ 270 daN	TPS 32x50				
RTRC 3000x80-1	80		400 daN	≈ 600 daN	TPK 32x80		35		10,0
RTRC 3000x80-2			200 daN	≈ 270 daN	TPS 32x80				

### Working Force Distribution

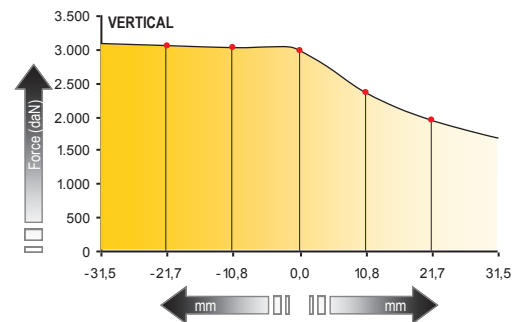
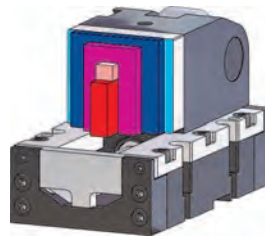
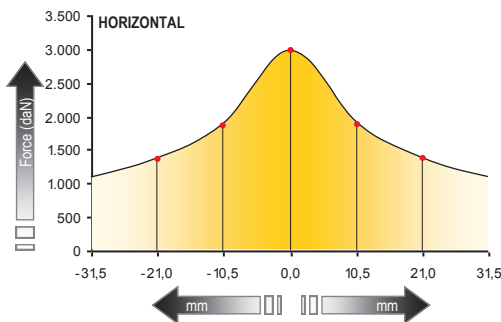

Maximum force that can be applied to the punch depending on eccentricity, so that the stress in the assembly is the same as it was when the punch was completely centered.

### Maximum Incline

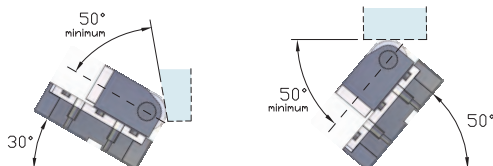

### How to order

RTRC 3000	x	80	-	1
Model		Stroke		Gas spring model

1 - TPK series  
2 - TPS series