

Model	A mm	B mm	C mm	D mm	E mm	F mm
RTRC 5000x50	190	56	88	103	140	20
RTRC 5000x80	220	86	118	103	140	20
RTRC 5000x100	260	126	158	120	157	30

Model	Smax mm	Max. punching force	Gas spring return force		Gas spring model	Max. working specifications		Max. width of driver	Kg
			Initial	Final		Velocity	Strokes / min		
RTRC 5000x50-1	50	5000 daN	400 daN	≈ 600 daN	TPK 32x50	0,5 m/s	40	40 mm	15,2
RTRC 5000x50-2			200 daN	≈ 270 daN	TPS 32x50				
RTRC 5000x80-1	80	5000 daN	400 daN	≈ 600 daN	TPK 32x80	0,5 m/s	35	40 mm	16,0
RTRC 5000x80-2			200 daN	≈ 270 daN	TPS 32x80				
RTRC 5000x100-1	100	5000 daN	400 daN	≈ 600 daN	TPK 32x100	0,5 m/s	25	40 mm	22,5
RTRC 5000x100-2			200 daN	≈ 270 daN	TPS 32x100				

Working Force Distribution

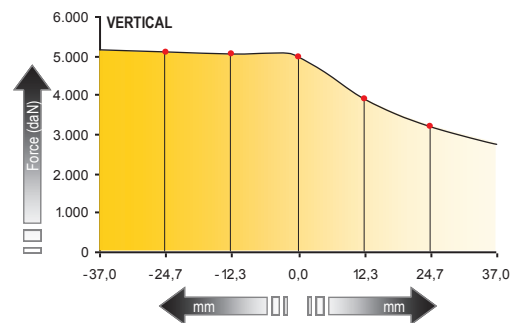
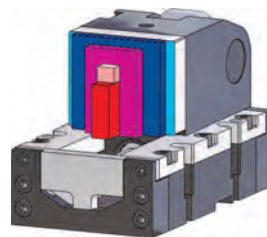
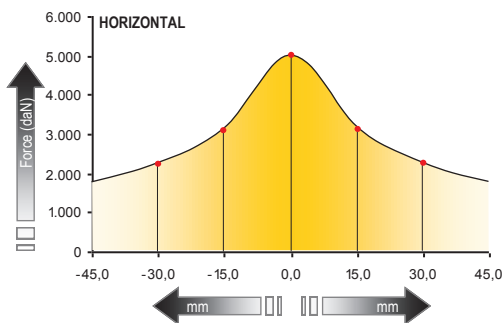

Maximum force that can be applied to the punch depending on eccentricity, so that the stress in the assembly is the same as it was when the punch was completely centered.

Maximum Incline

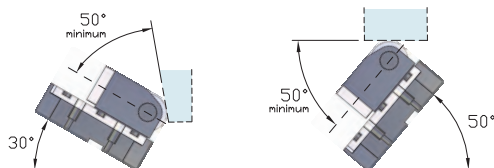

How to order

RTRC 5000 x 100 - 1

Model

Stroke

Gas spring model

1 - TPK series
2 - TPS series