

SinterLube® Mold Bushings, INCH

Inside Diameter

Nominal Pin Ø	L1 Length +.000/-.030	Catalog Number
3/4"	7/8	6-0607-845
	1 3/8	6-0613-845
	1 7/8	6-0617-845
	2 3/8	6-0623-845
	2 7/8	6-0627-845
7/8"	7/8	6-0707-845
	1 3/8	6-0713-845
	1 7/8	6-0717-845
	2 3/8	6-0723-845
1"	7/8	6-0807-845
	1 3/8	6-0813-845
	1 7/8	6-0817-845
	2 3/8	6-0823-845
	2 7/8	6-0827-845
	3 3/8	6-0833-845
1 1/4"	7/8	6-1007-845
	1 3/8	6-1013-845
	1 7/8	6-1017-845
	2 3/8	6-1023-845
	2 7/8	6-1027-845
	3 3/8	6-1033-845
1 1/2"	7/8	6-1207-845
	1 3/8	6-1213-845
	1 7/8	6-1217-845
	2 3/8	6-1223-845
	2 7/8	6-1227-845
	3 3/8	6-1233-845
2"	3 7/8	6-1237-845
	4 3/8	6-1243-845
	4 7/8	6-1247-845
	1 3/8	6-1613-845
	1 7/8	6-1617-845
	2 3/8	6-1623-845
2 1/2"	2 7/8	6-1627-845
	3 3/8	6-1633-845
	3 7/8	6-1637-845
	4 3/8	6-1643-845
	4 7/8	6-1647-845
	5 7/8	6-1657-845
3"	3 7/8	6-2013-845
	1 7/8	6-2017-845
	2 3/8	6-2023-845
3"	2 7/8	6-2027-845
	3 3/8	6-2033-845
	3 7/8	6-2037-845
3"	4 3/8	6-2043-845
	4 7/8	6-2047-845
	5 7/8	6-2057-845
3"	3 7/8	6-2437-845
	4 7/8	6-2447-845
	5 7/8	6-2457-845

Nominal Pin Ø	L1 Length +.000/-.030	Catalog Number
1 1/2"	7/8	6-1207-845
	1 3/8	6-1213-845
	1 7/8	6-1217-845
	2 3/8	6-1223-845
	2 7/8	6-1227-845
2"	3 3/8	6-1233-845
	3 7/8	6-1237-845
	4 3/8	6-1243-845
	4 7/8	6-1247-845
	1 3/8	6-1613-845
	1 7/8	6-1617-845
2 1/2"	2 3/8	6-1623-845
	2 7/8	6-1627-845
	3 3/8	6-1633-845
	3 7/8	6-1637-845
	4 3/8	6-1643-845
	4 7/8	6-1647-845
3"	5 7/8	6-1657-845
	3 7/8	6-2013-845
	1 7/8	6-2017-845
3"	2 3/8	6-2023-845
	2 7/8	6-2027-845
	3 3/8	6-2033-845
3"	3 7/8	6-2037-845
	4 3/8	6-2043-845
	4 7/8	6-2047-845
3"	5 7/8	6-2057-845
	3 7/8	6-2437-845
	4 7/8	6-2447-845
3"	5 7/8	6-2457-845

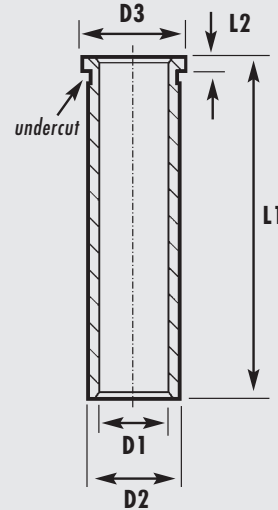

General Dimensions

Nom. I.D.	D1 +.0005 -.0000	D2 +.0005 -.0000	D3 +.000 -0.005	L2 +.000 -.005
3/4	0.7505	1.1255	1.3020	0.1870
7/8	0.8755	1.2505	1.4270	0.1870
1	1.0005	1.3755	1.5520	0.1870
1 1/4	1.2505	1.6255	1.8020	0.1870
1 1/2	1.5005	2.0005	2.1770	0.1870
2	2.0005	2.5005	2.6770	0.1870
2 1/2	2.5005	3.2505	3.4270	0.1870
3	3.0005	3.7505	3.9900	0.5000

Ejector Bushings

Nom. I.D.	D1 +.0005 -.0000	D2 +.0005 -.0000	D3 +.000 -.010	D4 +.000 -.001	L1 +.000 -.030	L2 +.000 -.005	L3 +.000 -.015	Catalog Number
3/4	0.7510	1.1255	1.302	1.124	1.500		1.000	6-0612-835
7/8	0.8760	1.2505	1.427	1.249	1.500		1.000	6-0712-835
1	1.0010	1.3755	1.552	1.374	1.750	.187	1.120	6-0814-835
1 1/4	1.2510	1.6255	1.802	1.624	1.750		1.120	6-1014-835
1 1/2	1.5010	2.0005	2.177	1.999	1.750		1.120	6-1214-835
2	2.0010	2.5005	2.687	2.499	2.250		1.620	6-1618-835

